



Eldo Road, Bury St. Edmunds, IP28 8PY

Rent - Asking Price £250,000

Deposit -

A charming three-bedroom semi-detached flint cottage, ideally positioned in the highly sought-after village of West Row. This delightful home offers generous and well-proportioned accommodation, including a spacious living/dining room perfect for both relaxing and entertaining, a modern fitted kitchen, and three comfortable bedrooms. Externally, the property benefits from a private garden providing a peaceful outdoor retreat, along with convenient off-road parking. An ideal opportunity for first-time buyers, growing families, or those seeking an attractive rental investment in a popular village location.

- FLINT STYLE COTTAGE
- OFF ROAD PARKING
- DOWNSTAIRS WC
- THREE BEDROOMS
- IDEAL FOR FIRST TIME BUYERS OR A FAMILY HOME
- SPACIOUS LIVING ROOM
- SEMI DETACHED
- OIL FIRED HEATING
- PRIVATE GARDEN
- CALL SHIRES TO VIEW



Council Tax Band: C - EPC Rating: C 71

Approx Gross Internal Area
74 sq m / 792 sq ft

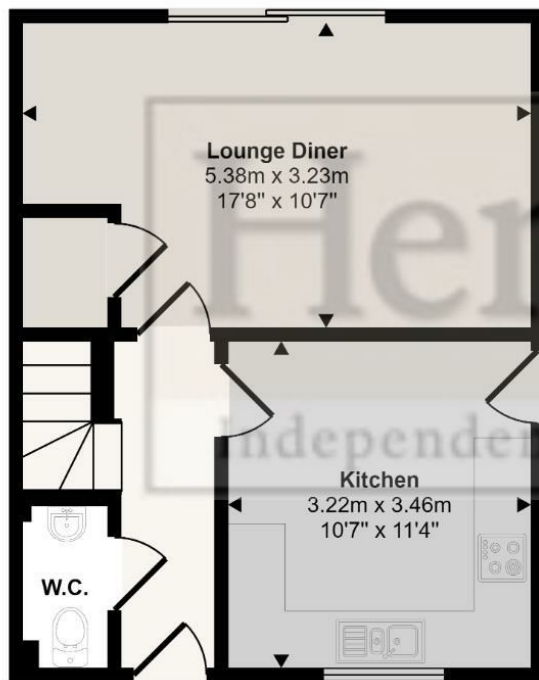

Ground Floor
Approx 37 sq m / 395 sq ft

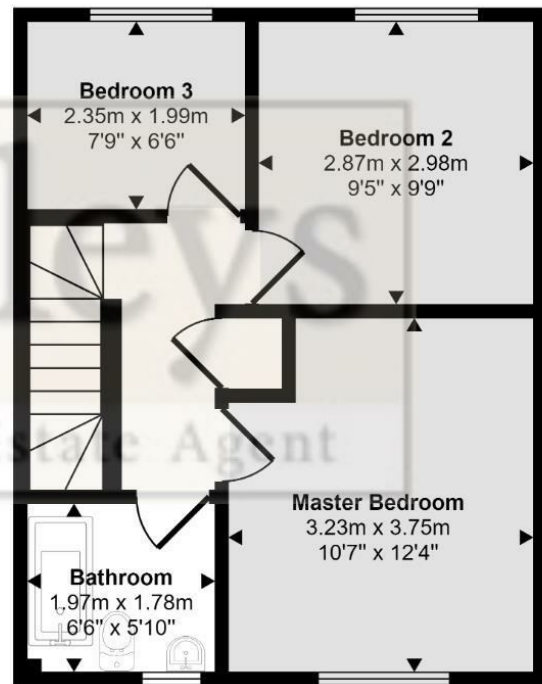

First Floor
Approx 37 sq m / 397 sq ft

This floorplan is only for illustrative purposes and is not to scale. Measurements of rooms, doors, windows, and any items are approximate and no responsibility is taken for any error, omission or mis-statement. Icons of items such as bathroom suites are representations only and may not look like the real items. Made with Made Snappy 360.

